

WOOD GUARD RAIL REQUIRED
 LEFT
 Sta. 926+95 to 927+12 Length 24 ft
 RIGHT
 Sta. 926+95 to 927+12 Length 24 ft

NEW CULVERTS REQUIRED
 Sta 927+07 18" Reinf. Concrete Pipe Culvert 40 ft
 Concrete Class B (-2 1/2%) 1.9 cu yds.
 Reinforcing Steel 30 pounds.

NEW DRIVEWAY CULVERTS REQUIRED
 Sta 920+12 Left- New 12" Ort. Galv. Metal Pipe Length- 20 ft
 Concrete Class B (1 1/2%) 1.1 cu yds.
DRIVEWAY CULVERTS TO BE REPAIRED
 Sta 921+70 Left 12" Concrete Pipe
 To be retained
 Build New Headwalls
 Concrete Class B (-2 1/2%) 1.1 Cu yds.
 Sta 924+50 Left 10" C. M. P. To be retained
 Build New Headwalls
 Concrete Class B (-2 1/2%) 1.1 Cu yds.

SUB-BASE OF GRAVEL REQUIRED
 Sta. 916+00 to 927+00 - 6" Sub-B

END OF R.F.P. No. 72

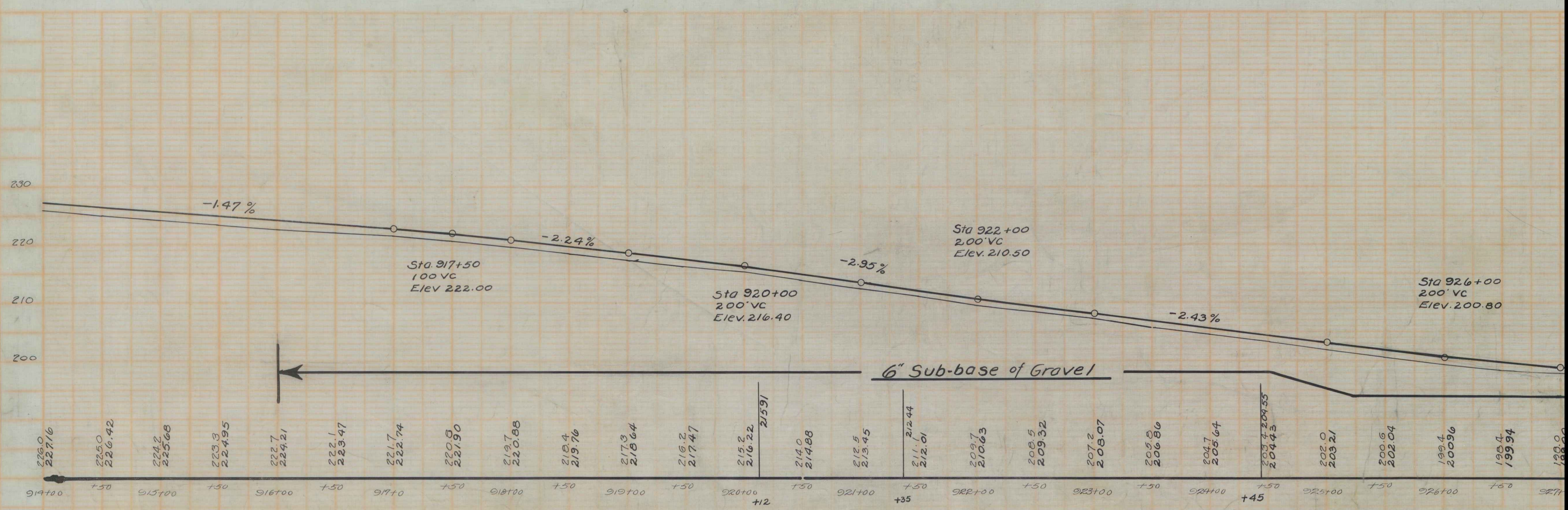
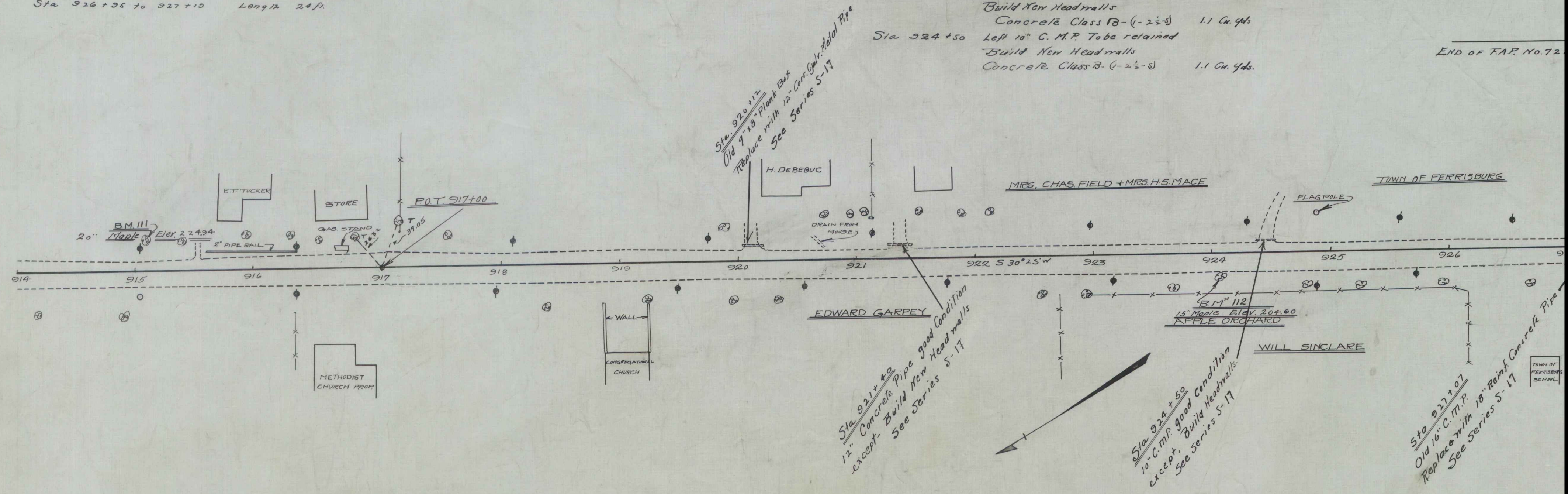

B.M. No. 111 Spike in 2 1/2" Maple Left of Sta. 915+11 Elev. 224.34
 B.M. No. 112 " 18" Elm Right " 924+00 " 204.60
 B.M. No. 113 Old B.M. No. 10 Spike in 30" Elm Left of Sta. 927+23 Elev. 200.50